

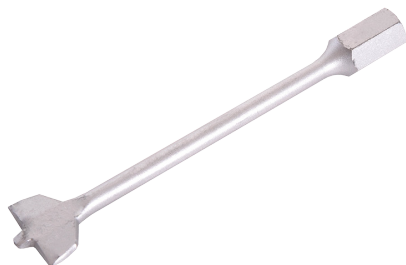

# DRIVER BIT

FOR CLEMAN® RISER PEDESTAL



## BENEFITS

- The bit fits directly into the chuck of the screwdriver.
- The bit has a standard 10 mm hexagonal shape to fit on a 10 mm wrench, a 10 mm socket.

## APPLICATIONS

- Adjusts the height or pre-adjusts the risers using a screwer.

## RECOMMENDATIONS

- Pre-adjustment: for information, on an electric screwdriver with 20 positions, position the adjustment ring on the mark 7. Moderate speed.
- Adjustment: use a pipe wrench, ratchet or T-wrench with a 10 mm socket.
- Use a battery-powered screwdriver with a chuck and not an electric screwdriver.

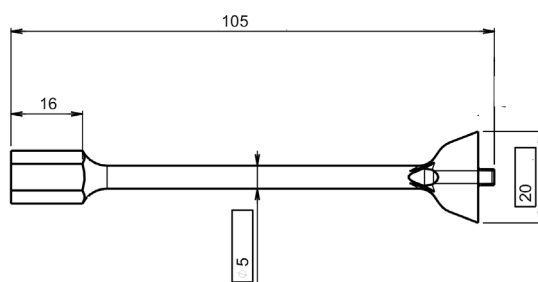

## TECHNICAL DETAILS

- Material: hardened steel
- Colour: aluminium grey
- Length: 105 mm
- Thickness: 4 mm
- Maximum torque: 30 N.m

## PACKING

- Per unit (128 boxes per pallet)

Document protected by copyright. Any reproduction, copy, extraction, reuse in others publications, translation or adaptation, display, distribution or modification, in whole or in part, without the written consent of TMP CONVERT is strictly prohibited and will be sanctioned. TMP CONVERT reserves the right to add, modify or delete information to any time without warning.



[www.jouplast.com](http://www.jouplast.com)

